

General Notes:

1. Fire beam in Lower hall at 11.90m above vestibule floor;
2. Fire beam in Upper Hall at 8.15m above upper hall floor;
3. Temporary Stairs Protection (TSP2, 3 and 4) of mandatory use while moving objects in and out of the rooms.
4. Portable Audio Visual near the entrance to Lower Hall, normally kept inside the cupboard;
5. Benches and Torcheres can be removed by GF Team if part of the rental agreement;
6. Nelson Room Lift has a capacity of 630Kg/ 8 people;
7. Painted Hall Lift has a capacity of 500Kg, no height limit.

GENERAL NOTES:

1. Do not scale from this drawing. Use figured dimensions only. Contractor to check dimensions on site prior to construction and notify CA of any discrepancy.
2. This drawing is to be read in conjunction with all other relevant contract drawings, specifications & Schedules.
3. If in doubt: Ask
4. Martin Ashley Architects shall be notified in writing of any discrepancies.

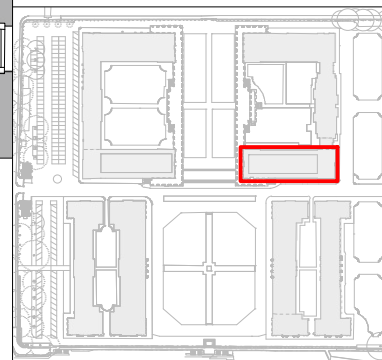
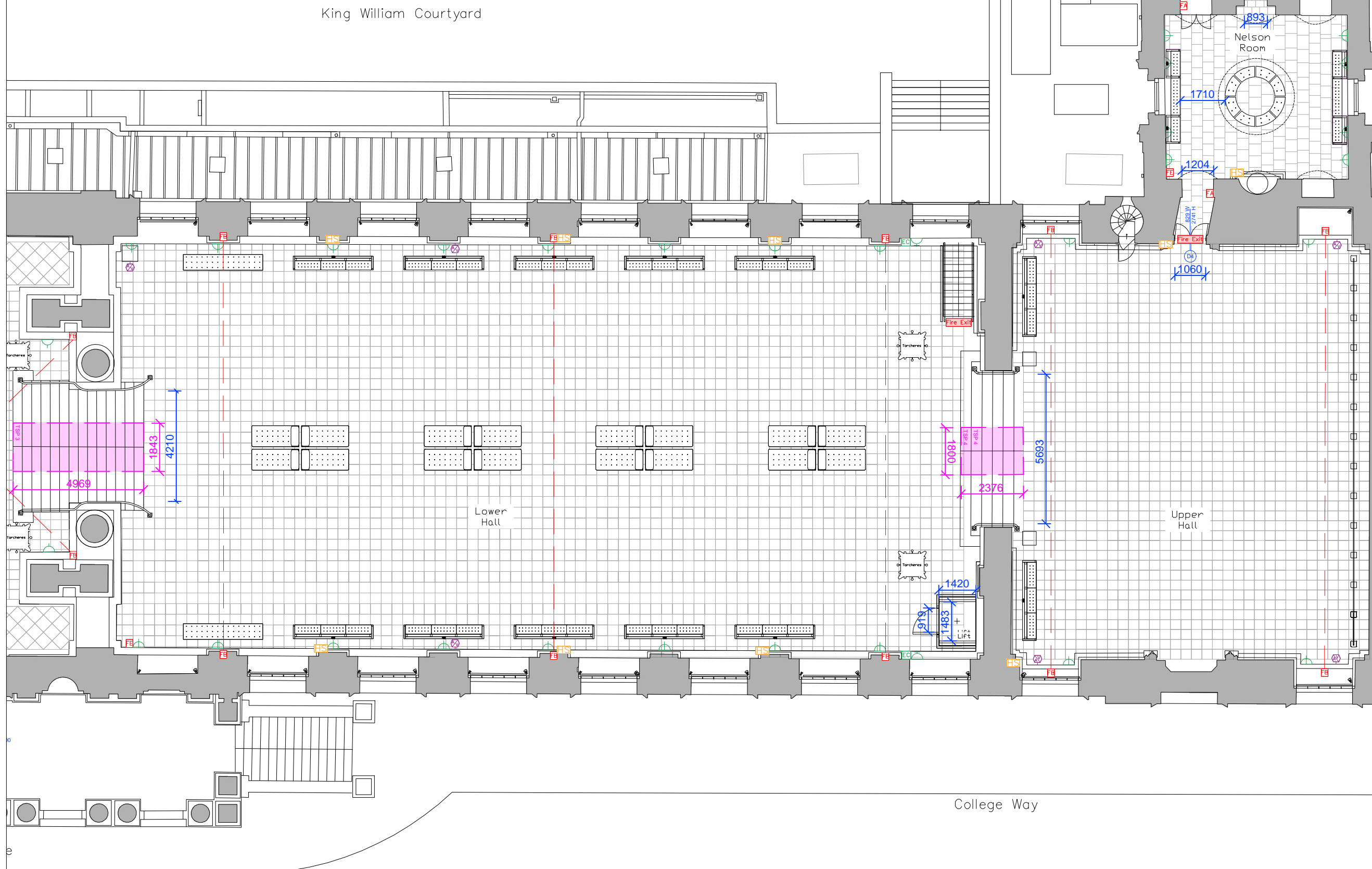

Key

- Double Socket (13MP?)
- Single Socket (3 Phase - 63MP - 5 pin)
- Electric Cupboard
- PC Tower (Digital Presentation on NR)
- Fusebox
- Audio Visuals
- Humidity Sensor
- Fire Extinguisher
- Fire Alarm
- Fire Beam
- Fire Beam Direction
- Temporary Stair Protection (TSP)
- Fire Exit Sign

Rev.	Date	Reason For Issue	Chk.
B	20.02.24	Extra measurements	KK
A	30.01.24	Feedback update	KK

Status
Preliminary

M MARTIN ASHLEY ARCHITECTS
745, 7th Floor, Regal House, 70 London Road, Twickenham, Middlesex, TW1 3QS
T +44 (0) 20 8948 7788
www.ma-arch.co.uk

Client
OLD ROYAL NAVAL COLLEGE

Project
**PAINTED HALL
LOWER, UPPER HALL AND
NELSON ROOM SERVICES**

Title
**PAINTED HALL
FIRST FLOOR
As Existing**

Date	Scale	Revision
Dec 2023	1:150 @ A3	
Checked By	Drawn By	Revision
KK	CO	
Drawing Number	Revision	
2194-99/00/44	B	

PAINTED HALL - FIRST FLOOR
As Existing, 1:150

