

**General Notes:**

1. All widths of doors are the minimum width, from handle to handle;
2. Fire beam in vestibule placed at 15m height;
3. Only one socket available in each side of door 2. Single Sockets in each side of the stairs not available;
4. Temporary Stairs Protection (TSP2, 3 and 4) of mandatory use while moving objects in and out of the rooms;
5. Temporary Stairs Protection Ramp (TSP1) allows machinery to enter the vestibule, if needed.

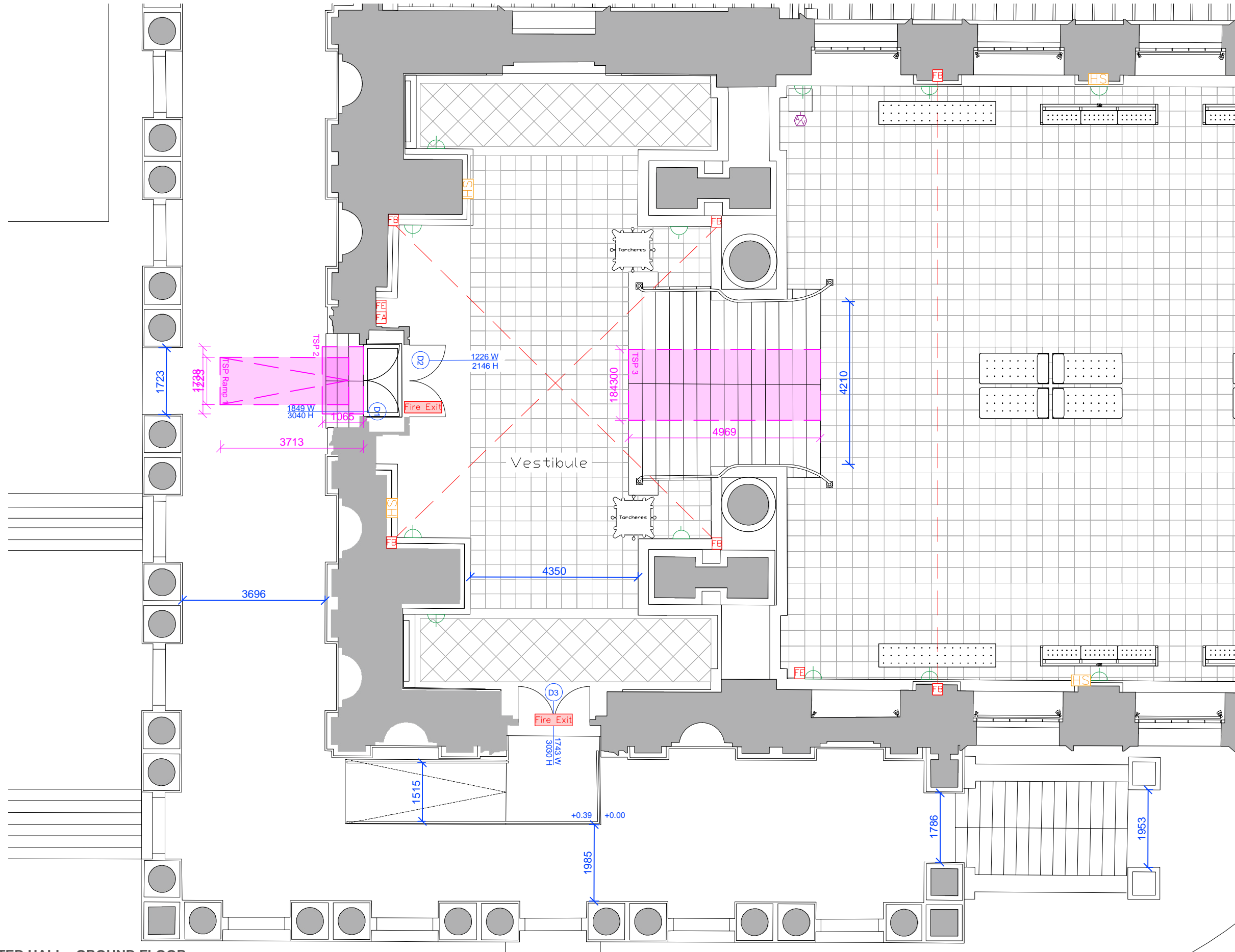

**PAINTED HALL - GROUND FLOOR**  
As Existing, 1:100

**GENERAL NOTES:**

1. Do not scale from this drawing. Use figured dimensions only. Contractor to check dimensions on site prior to construction and notify CA of any discrepancy.
2. This drawing is to be read in conjunction with all other relevant contract drawings, specifications & Schedules.
3. If in doubt: Ask
4. Martin Ashley Architects shall be notified in writing of any discrepancies.

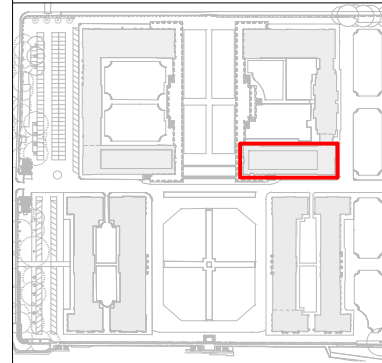

**Key**

- Double Socket (13MP?)
- Single Socket (old hardware?)
- Electric Cupboard
- Audio Visuals
- Humidity Sensor
- Fire Beam
- Fire Extinguisher
- Fire Alarm
- Fire Beam Direction
- Temporary Stair Protection (TSP)
- Fire Exit Sign

Rev.	Date	Reason For Issue	Chk.
B	20.02.24	Extra measurements	KK
A	30.01.24	Feedback update	KK

Status  
**Preliminary**

**MARTIN ASHLEY ARCHITECTS**  
745, 7th Floor, Regal House, 70 London Road, Twickenham, Middlesex, TW1 3QS  
T +44 (0) 20 8948 7788  
www.ma-arch.co.uk

Client  
**OLD ROYAL NAVAL COLLEGE**

Project  
**PAINTED HALL VESTIBULE SERVICES**

Title  
**PAINTED HALL GROUND FLOOR As Existing**

Date	Dec 2023	Scale	1:100 @ A3
Checked By	KK	Drawn By	CO
Drawing Number	2194-99/00/43		Revision
			<b>B</b>